





versatile projector



retro chic
suspension

classical on the ceiling



wall mounted discretion

Anatomy

BIM

DIM

IES

LED

2020B

350°

2020B

90°

ALVER

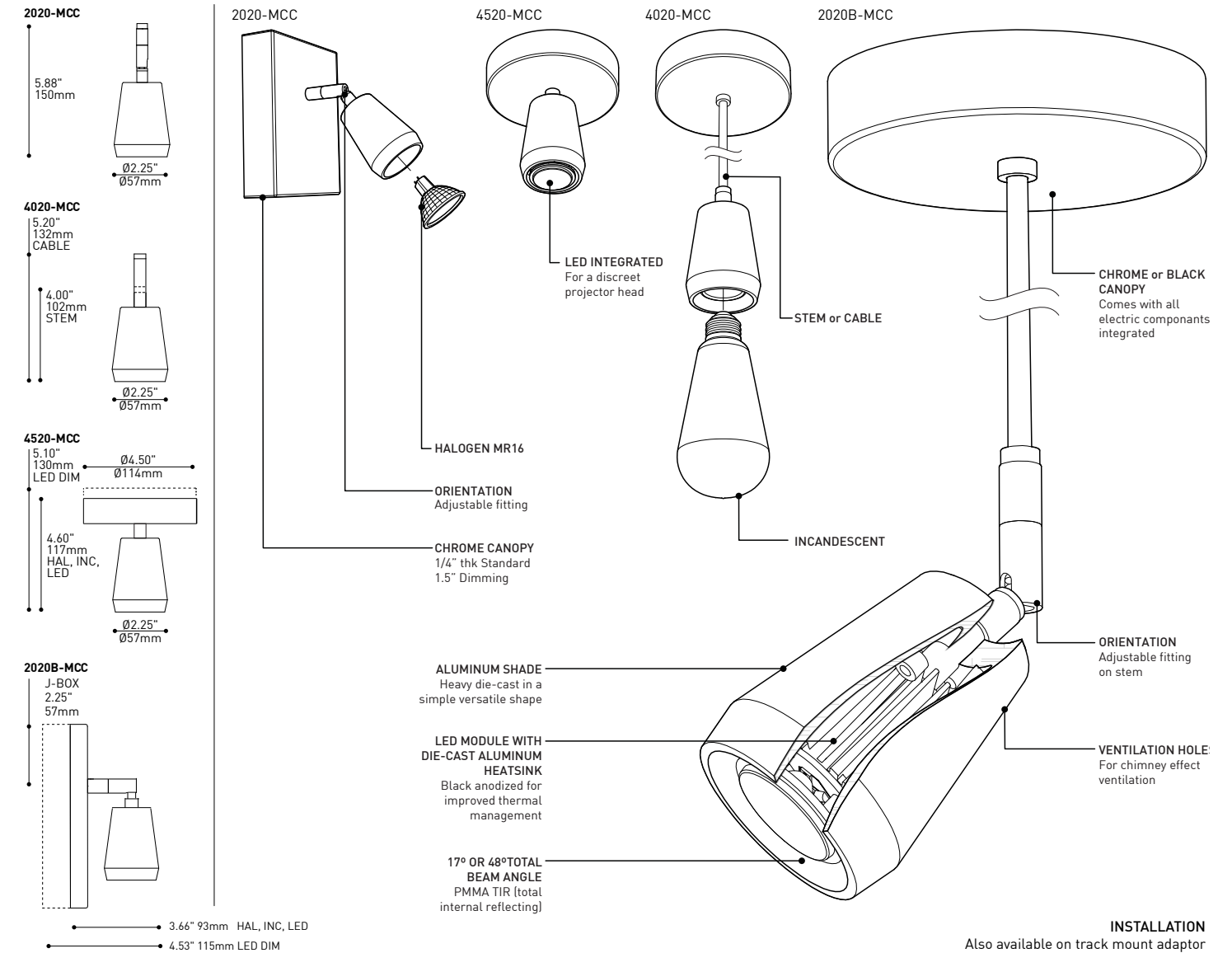

SPECIFICATIONS

	LED	HALOGEN	INCANDESCENT
LIGHT SOURCE	4 x high powered LEDs on MCPCB - total ±4 w	MR16C, GU5.3 Base - 50W	Inc Medium Base - 60W
MODULE	UL recognized - made in USA	N/A	N/A
DELIVERED LUMENS	330 lm (3000K) - 350 lm (4000K)	N/A	N/A
CRI	80 CRI (3000K) - 80 CRI (4000K)	N/A	N/A
HOUSING	Die-cast aluminum		
HEATSINK	Black anodized aluminium	N/A	N/A
LIGHT DISTRIBUTION	Directional projector (2020(B))/Direct (4020)		
OPTICS	Total Internal Reflection (TIR) of 17° & 48° beam angle	N/A	N/A
VOLTAGE	120V (DP) or 120-277V (DV or non-dimming)	120V or 277V	120V
DRIVER	Constant Current driver 350 mA, UL Recognized	ELV transformer	
DIMMING	Phase Dimming (DP) and 0-10V Dimming (DV)	Dimmable	Dimmable
LM-79	In process		
WARRANTY	5 years (on electronic components)	3-5 years on transformer	
CERTIFICATION	CSA recognized		

Photometric Report

Alver

xx20-MCC-LED.4.30.48
3000K - 4W - 48°

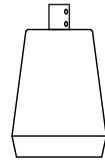

Initial lumens (lm):	415
Delivered lumens (lm):	330
Input watts (W):	5.36
Number of LED's:	4
Lumens per LED:	82,5
Distribution:	Direct
Efficiency (%):	79.5
Efficacy (lm/W):	62
Photometric type	C

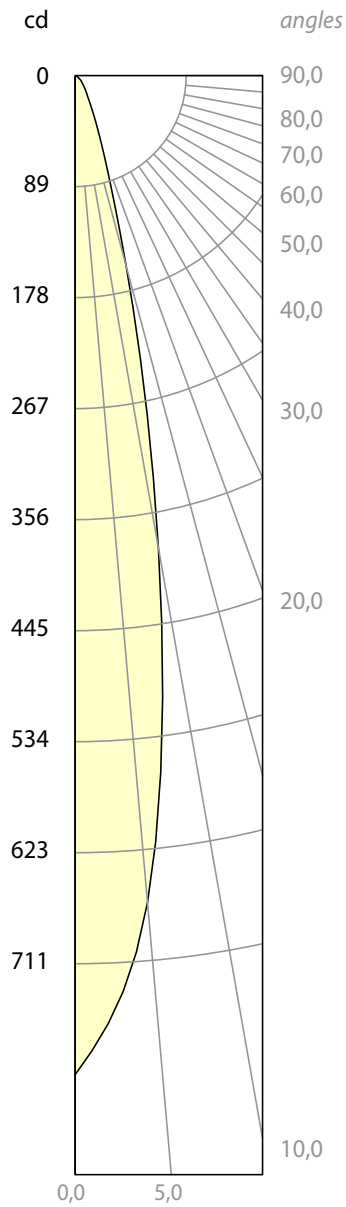

Alver

xx20-MCC-LED.4.30.48
3000K - 4W - 48°

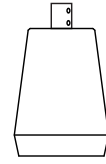

Initial lumens (lm):	415
Delivered lumens (lm):	330
Input watts (W):	5.36
Number of LED's:	4
Lumens per LED:	82,5
Distribution:	Direct
Efficiency (%):	79.5
Efficacy (lm/W):	62
Photometric type	C

