



ECLIPSE

 EUREKA

ECLIPSE

Wall Recessed

10293

Designed to fit standard wall thickness
Ready to paint, seamless plastered installation
Glare-free indirect illumination

Decorative front plate available in shatter-proof mirror or ready to paint white finish

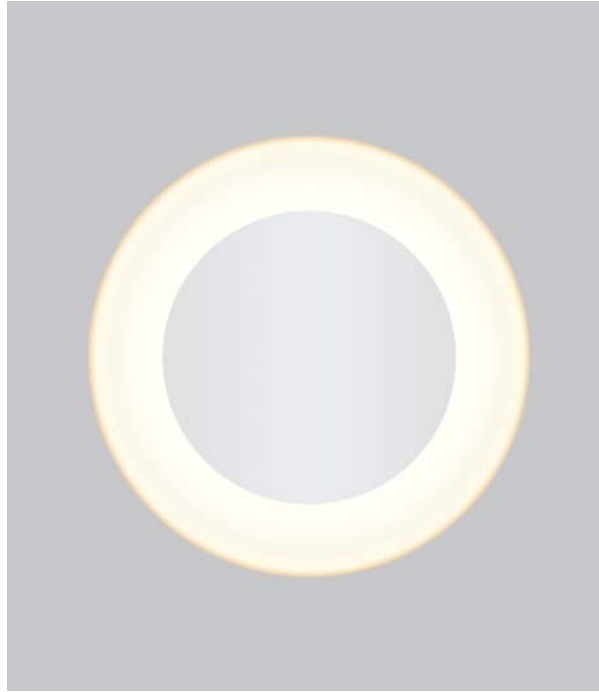

ECLIPSE

Wall Recessed Anatomy

Cutting dimensions

10293  14.25" x 14.25"
362mm x 362 mm

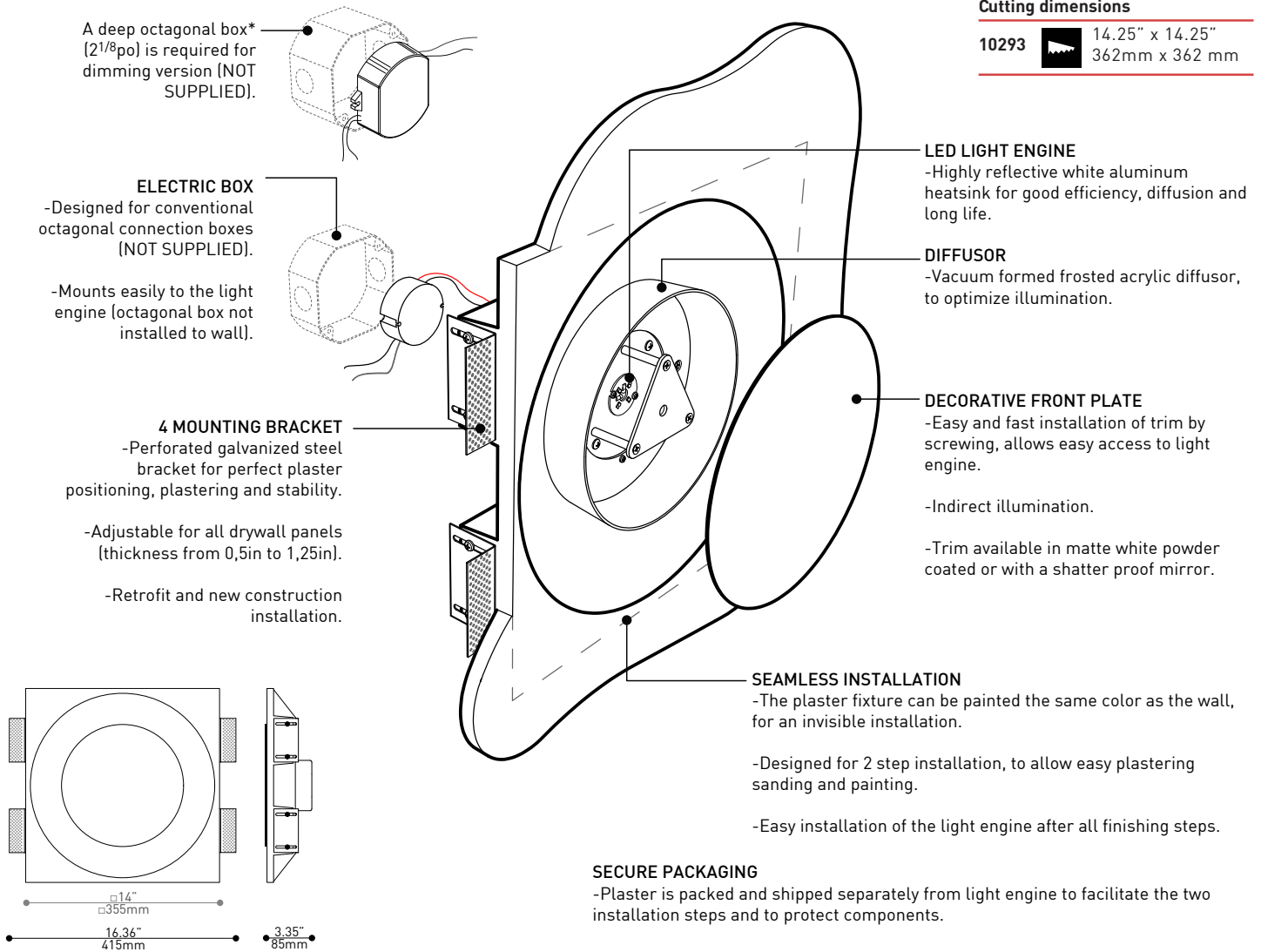

SPÉCIFICATIONS

LIGHT SOURCE

MODULE

LUMENS (ESTIMATED)

CRI

ROHS

CCT

VOLTAGE

DRIVER

DIMMING

LM-79

MOUNTING

STRUCTURE

THERMAL MANAGEMENT

WARRANTY

8W LED

8W LED LUXEON Rebel PLUS

LED Light engine with integrated junction box and heatsink

340 lm

80 CRI (3000K) - 80 CRI (4000K)

Compliant

3-step MacAdam Ellipse

120V

Constant current driver 700mA, UL Recognized

N / A

In process

Recessed fully integrated

Plaster

Heatsink fully integrated with light engine

5 years for LED and driver system

8W LED DIMMING

Constant current driver 700mA, UL Recognized

Phase Dimming

*RECOMMENDED IBERVILLE MODELS : BC 54171-K, BC 54171-L, BC 54171-LA

BIM

IES

LED



ECLIPSE 10293

PROJECT PROJET

SPEC TYPE

NOTES

ORDERING SPECIFICATION SPÉCIFICATION DE COMMANDE

CODE

MODEL MODÈLE

10293

10293 ECLIPSE

LIGHT SOURCE SOURCE LUMINEUSE

(WATTAGE, LAMP TYPE, LAMP FORM, BASE TYPE, OTHER INFO)

LED.8.30 8W, LED 3000K (WARM)

LED.8.40 8W, LED 4000K (NEUTRAL)

VOLTAGE VOLTAGE

120V

120V 120 VOLT

DIMMING OPTION OPTION DE GRADATION

DHP HATCH PHASE DIMMING ELECTRONIC DRIVER

STRUCTURE FINISH FINI STRUCTURE

WH WHITE

MIR MIRROR

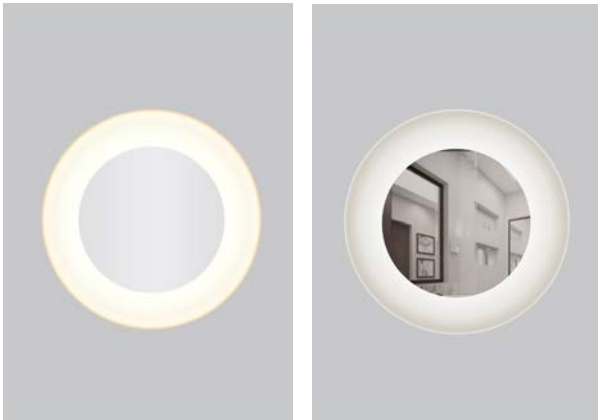
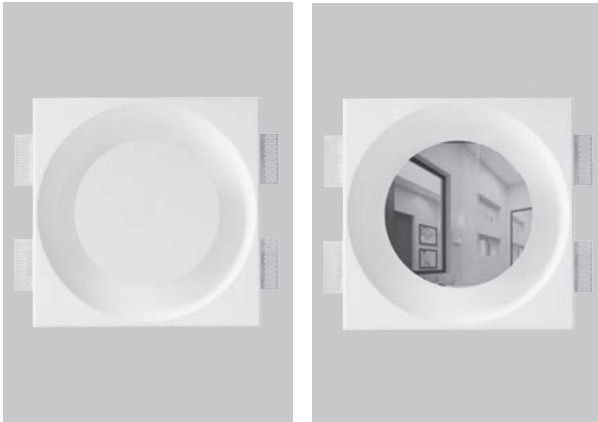

PRODUCT CHARACTERISTICS CARACTÉRISTIQUES DU PRODUIT

Design:

Painted the color of your wall or your ceiling, this recessed luminaire is designed to be fully integrated to your environment. The parabolic molded plaster shape and 8 watt LED light engine provide indirect lighting and create a sleek and dynamic look. The flat finishing plate is available in white or with a shatter proof mirror.

Light Source:

8W LED available in 3000K (Warm white) & 4000K (Neutral white).

Installation:

Designed to fit standard wall depth (3.5in) and to accommodate wall panel thickness from 0.5in to 1.25in. Can be installed on the ceiling.

Structure:

Reinforced Gypsum Plaster with adjustable installation brackets. Fully accessible light engine and connection box.

Certified:

c-CSA-us

Conception:

Peint de la couleur de votre mur ou de votre plafond, ce luminaire encastré est conçu pour s'intégrer complètement à votre environnement. La forme parabolique moulée en plâtre et le module d'éclairage DEL de 8 watts procurent un éclairage indirect et crée un look épuré et dynamique. La plaque frontale décorative est disponible en blanc ou avec un miroir incassable.

Source lumineuse:

DEL 8W disponible en 3000K (blanc chaud) ou 4000K (blanc neutre).

Installation:

Conçu pour s'intégrer aux murs d'épaisseur standard (3,5po) et s'adapter aux panneaux de gypse de 0,5po à 1,25po d'épaisseur. S'installe aussi au plafond.

Structure:

Plâtre renforcé avec des supports d'installation ajustables. Module d'éclairage DEL et boîte de connexion entièrement accessible.

Certifié:

c-CSA-us



14.25" X 14.25" (362MM X 362MM)

10293

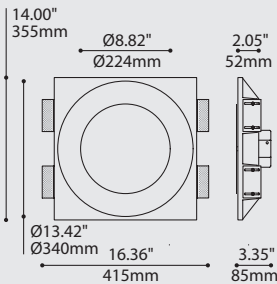

ECLIPSE

Wall Recessed
Photometry

10293-LED.8

8W LED CONSTANT CURRENT 700mA

Number of lamps: 4
Lumens per lamp: 150
Input watts: 8.4
Distribution: Indirect
Efficiency: 20
Photometric type: C

