

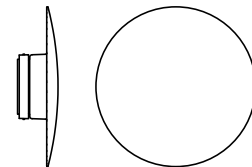

EUREKA

Iris

3443-LED304-ANTE-CLR
4w LED Clear diffuser



Photometric Report

CCT (K):	3000
Initial lumens (lm):	500
Delivered lumens (lm):	231
Input watts (W):	5.4
Number of LED's:	4
Lumens per LED:	125
Distribution:	Direct-Indirect
Efficiency (%):	46.3%
Efficacy (lm/W):	42.8
Photometric type	C

Luminous dimensions

Luminous shape:	Rectangle
Units:	in (mm)
0-180 Axis:	12 (343)
90-270 Axis:	12 (220)
Height:	2.6 (65)

Luminaire spacing criteria

2 luminaires, plane 0:	4.49
2 luminaires, plane 90:	4.49
4 luminaires:	4.11

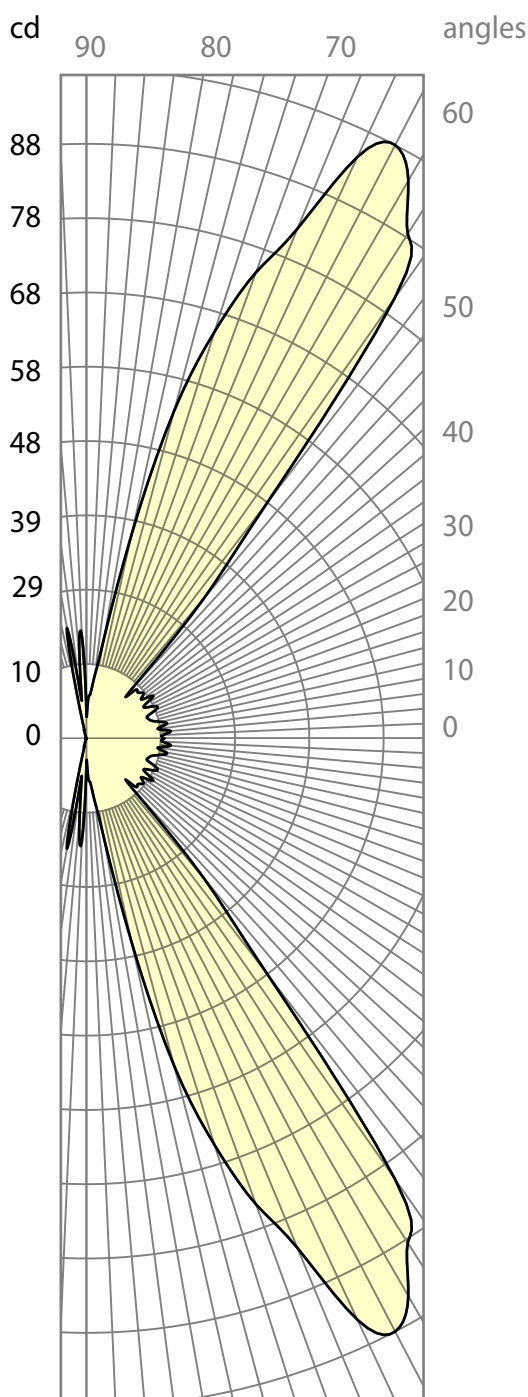

90 - 270