

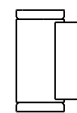

EUREKA

SILENE OUT

3455-KDB-2XLED.4
2 X 4W LED MODULES CONSTANT CURRENT (350 mA)

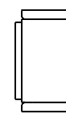

Photometric Report

CCT (K):	4000K
Initial lumens (lm):	830
Delivered lumens (lm):	615
Input watts (W):	7.86
Number of LED module's:	2
Lumens per LED module:	415
Distribution:	Direct-Indirect
Efficiency (%):	74.2
Efficacy (lm/W):	78.2
Photometric type	C

Luminous dimensions

Luminous shape:	Rectangle
Units:	in (mm)
0-180 Axis:	0.143 (3.63)
90-270 Axis:	0.127 (3.23)
Height:	0.192 (4.88)

Luminaire spacing criteria

2 luminaires, plane 0:	0.73
2 luminaires, plane 90:	0.73
4 luminaires:	0.76

----- 0
————— 90

