

1

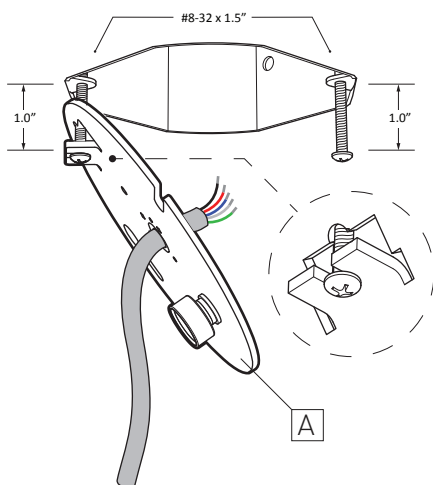

2

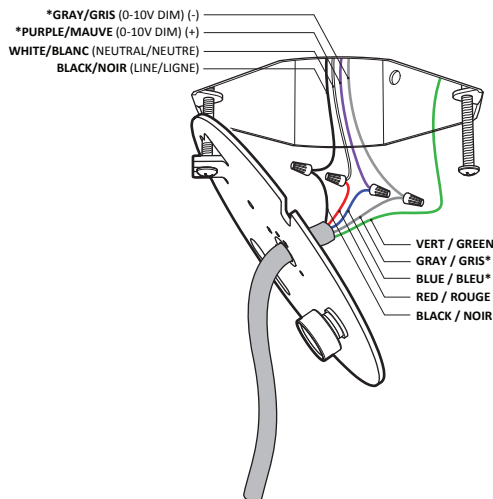

3

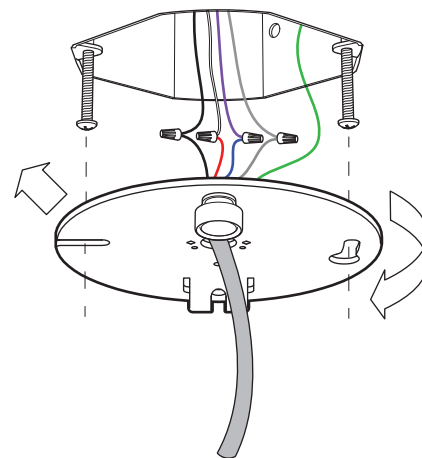

\*ONLY FOR 0-10V DIMMING / SEULEMENT POUR 0-10V DIMMING

\*ADJUST FIXTURE HEIGHT WITH INCLUDED STRAIN RELIEF BEFORE SCREWING PLATE ON

4

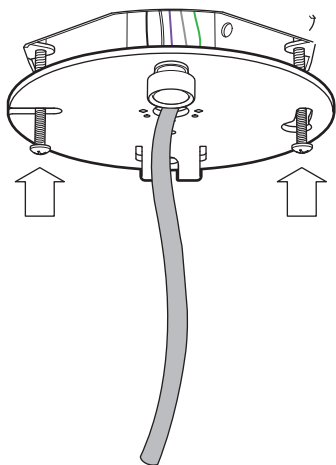

5

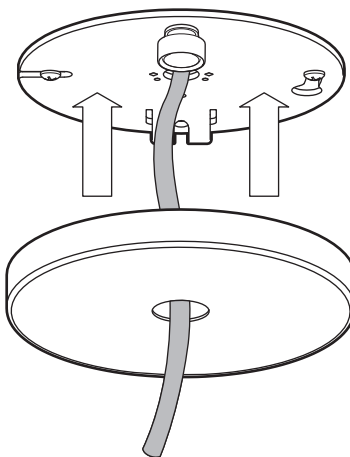

6

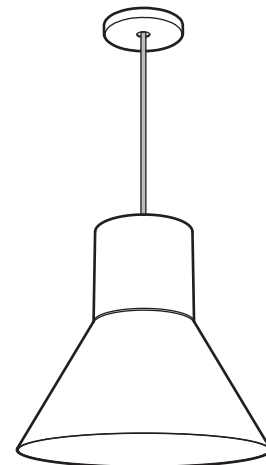

## INSTALLATION

1- INSERT BOTH #8-32 SCREWS LEAVING A 1.0" DISTANCE BETWEEN THE SCREW HEAD AND THE JUNCTION BOX. HANG THE MOUNTING PLATE [A] ON ONE OF THE SCREW HEADS USING THE SLOT IN THE FOLDED FLAP

2- MAKE CONNECTIONS:

|                            |   |            |
|----------------------------|---|------------|
| *PURPLE WIRE (0-10V DIM +) | = | BLUE WIRE  |
| *GRAY WIRE (0-10V DIM -)   | = | WHITE WIRE |
| BLACK WIRE (LINE)          | = | BLACK WIRE |
| WHITE WIRE (NEUTRAL)       | = | RED WIRE   |
| GREEN WIRE                 | = | GROUND     |

\* ONLY FOR 0-10V DIMMING

3- DETACH MOUNTING PLATE FROM FOLDED FLAP AND FIX IN PLACE USING THE TWO KEYHOLE SLOTS

4- TIGHTEN DOWN SCREWS

5- LIFT CANOPY INTO POSITION

## INSTALLATION

1- INSÉRER LES DEUX VIS #8-32 EN LAISSANT UN ESPACE DE 1.0" ENTRE LES TÊTES DE VIS ET LA BOÎTE DE JONCTION. SUSPENDRE LA PLAQUE DE MONTAGE [A] SUR L'UNE DES VIS EN UTILISANT L'OUVERTURE DE L'AILETTE

2- FAIRE LES CONNEXIONS:

|                          |   |              |
|--------------------------|---|--------------|
| *FIL MAUVE (0-10V DIM +) | = | FIL BLEU     |
| *FIL GRIS (0-10V DIM -)  | = | FIL BLANC    |
| FIL NOIR (PHASE)         | = | FIL NOIR     |
| FIL BLANC (NEUTRE)       | = | FIL ROUGE    |
| FIL VERT                 | = | MISE À TERRE |

\* SEULEMENT POUR 0-10V DIMMING

3- DÉTACHER LA PLAQUE DE MONTAGE DE L'AILETTE ET LA FIXER AUX VIS À L'AIDE DES DEUX TROUS DE SERRURE

4- RESSÉRER LES VIS

5- LEVER LE PAVILLON EN POSITION



225 de Liège Ouest, Suite #200  
Montréal (QC), Canada H2P 1H4  
Tel : 514.385.3515 Fax : 514.385.4169  
www.eurekalighting.com



4273