

INSTALLATION MAINTENANCE

Ceiling Fixture Plafonnier

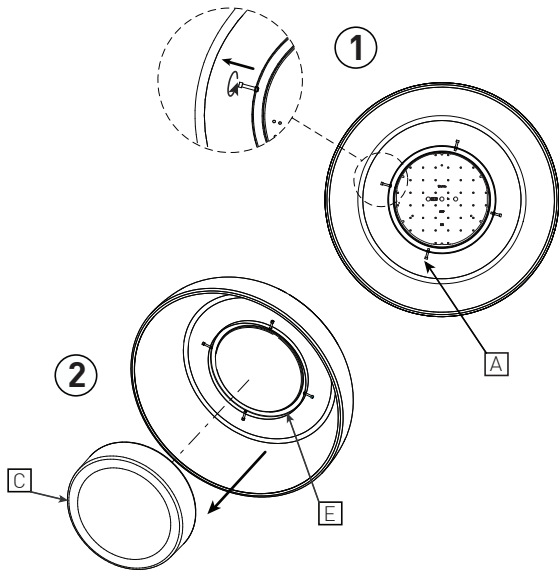

FOR FLUORESCENT
ONLY / POUR
FLUORESCENT
SEULEMENT

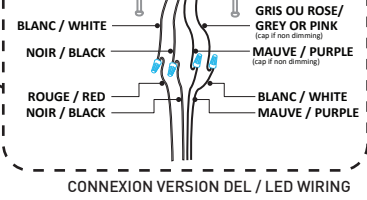
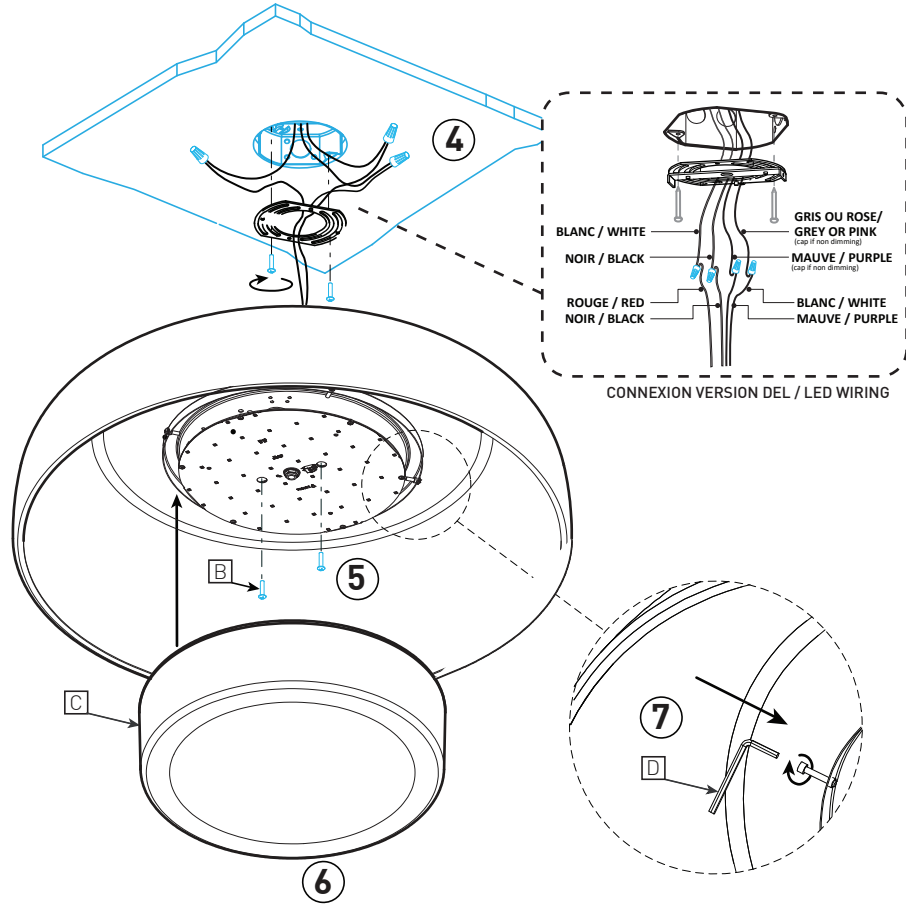
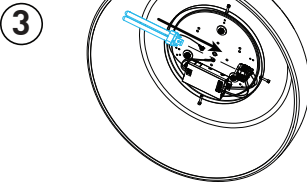

BULBS
AMPOULES



2XCF.SP.13

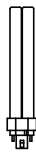

CF.D.26

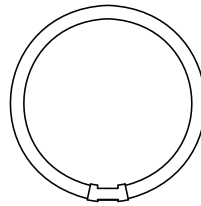

F.T5.C.22

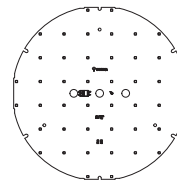

LED.10

INSTALLATION

- 1- LOOSEN 4-WAY #8-32 SOCKET HEAD CAP SIDE MOUNTING SCREWS [A] USING YOUR FINGERS.
- 2- REMOVE GLASS [C]
- 3- INSERT LIGHT BULB (NOT INCLUDED) INTO LIGHT SOCKET. (NOT LED)

INSTALLATION ON 4" JUNCTION BOX

- 4- INSTALL THE UNIVERSAL MOUNTING PLATE, AND MAKE ALL WIRING CONNECTION.
- 5- ATTACH FIXTURE WITH TWO #8-32 SCREWS [B] (CAREFUL NOT TO DAMAGE LED BOARD)
- 6- PLACE THE GLASS SHADE [C] ON TOP OF THE ROUND MOUNTING PLATE.
- 7- FINGER-TIGHTEN THE SHADE INTO PLACE WITH THE 4-WAY #8-32 SOCKET HEAD CAP SIDE MOUNTING SCREWS [A]. FASTEN IT FIRMLY USING THE 9/64 ALLEN KEY PROVIDED [D].

MAINTENANCE

LOOSEN THE MOUNTING SCREWS [E] USING YOUR FINGERS. REMOVE THE GLASS SHADE [C]. INSERT LIGHT BULB [S] (NOT SUPPLIED) AND SCREW DOWN THE GLASS SHADE [C].

INSTALLATION

- 1- DESSERER À LA MAIN LES (4) VIS À TÊTE CYLINDRIQUE À SIX PANS CREUX #8-32 FOURNIES [A].
- 2- ENLEVER LE VERRE [C]
- 3- INSÉRER L'AMPOULE (NON FOURNIE) DANS LA DOUILLE (SAUF POUR DEL).

INSTALLATION SUR LA BOÎTE ELECTRIQUE 4"

- 4- INSTALLER LA PLAQUE UNIVERSELLE ET FAIRE LA CONNEXION DES FILS.
- 5- FIXER LE LUMINAIRE À L'AIDE DES (2) VIS DE MONTAGES #8-32 FOURNIES [B] (ATTENTION DE NE PAS ENDOMMAGER LE MODULE DEL)
- 6- PLACER L'ABAT-JOUR EN VERRE [C] PAR DESSUS LA PLAQUE RONDE
- 7- VISSER À LA MAIN LES (4) VIS DE MONTAGE [A] POUR FIXER L'ABAT-JOUR. VISSER EN PLACE AVEC LA CLÉ ALLEN 9/64 FOURNIE [D].

MAINTENANCE

DÉVISSER À LA MAIN LES (4) VIS DE MONTAGE. RETIRER L'ABAT-JOUR DE VERRE [C]. INSÉRER L'AMPOULE (NON FOURNIE) ET RÉINSTALLER L'ABAT-JOUR DE VERRE [C].



225 de Liège Ouest, Suite #200
Montréal (QC), Canada H2P 1H4
Tel : 514.385.3515 Fax : 514.385.4169
www.eurekalinghting.com



4654B
Ollo