

VERNER 4273-14

QUICKSHIP

PROJECT PROJET

SPEC TYPE

NOTES



FINISH FINI



BLKE



WHE

4273-14

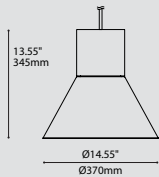

ORDERING SPECIFICATION SPÉCIFICATION DE COMMANDE

CODE

QUICKSHIP

QS5 QUICKSHIP 5 DAYS - MAXIMUM 5 UNITS QUICKSHIP 5 JOURS - MAXIMUM 5 UNITÉS
 QS10 QUICKSHIP 10 DAYS - MAXIMUM 20 UNITS QUICKSHIP 10 JOURS - MAXIMUM 20 UNITÉS

MODEL MODÈLE

4273-14 VERNER

4273-14

LIGHT SOURCE SOURCE LUMINEUSE

LED REGULAR OUTPUT
 LED.HO HIGH OUTPUT

COLOR TEMPERATURE TEMPÉRATURE DE COULEUR

30 3000K
 35 3500K
 40 4000K

COLOR RENDERING INDEX (CRI) INDICE DE RENDU DE COULEUR (IRC)

80 80+ CRI

80

VOLTAGE VOLTAGE

120V 120 VOLT
 277V 277 VOLT

DIMMING OPTION OPTION DE GRADATION

DV 0-10V DIMMING (120V-277V)
 DP PHASE DIMMING (120V ONLY)

LED DIMMING DRIVER IS STANDARD IN THIS PRODUCT, PLEASE SPECIFY YOUR DIMMING TYPE.

STEM OR CABLE TIGE OU CABLE

C CABLE, FIELD ADJUSTABLE

C

STEM OR CABLE LENGTH LONGUEUR DE TIGE OU CABLE

60 60" CABLE (STD LENGTH)
 ** CUSTOM CABLE LENGTH (PLEASE SPECIFY)
 FOR OVERALL LENGTH, PLEASE CONTACT YOUR EUREKA REPRESENTATIVE.

CANOPY FINISH FINI PAVILLON

BLKE BLACK FINE TEXTURE
 WHE WHITE FINE TEXTURE

SHADE FINISH FINI ABAT-JOUR ^(A) ^(B)

BLKE BLACK FINE TEXTURE
 WHE WHITE FINE TEXTURE
^(A) SHADE INTERIOR IS ALWAYS WHITE
^(B) SHADE FINISH DICTATES THE CABLE COLOR

DIFFUSER FINISH FINI DIFFUSEUR

WH WHITE

WH

PRODUCT CHARACTERISTICS CARACTÉRISTIQUES DU PRODUIT

BIM DIM EMB IES LED

DESIGN:

Verner, at its core, is a powerful light engine fused to a timeless geometric aluminum shell. A diffusion dome hidden inside the shade makes for a pleasant surprise when you look up.

INSTALLATION:

Single power cable or stem for a minimalist look.

LIGHT SOURCE:

A highly powerful COB type light source project a light, softened by a polymer diffusion dome to create an illumination that is efficient, yet soft to the eye. Many control options available.

SHADE:

Precision spun aluminum shade, with a white internal finish for optimal light reflection.

CERTIFIED:

c-CSA-us

VERNER 4273-XX

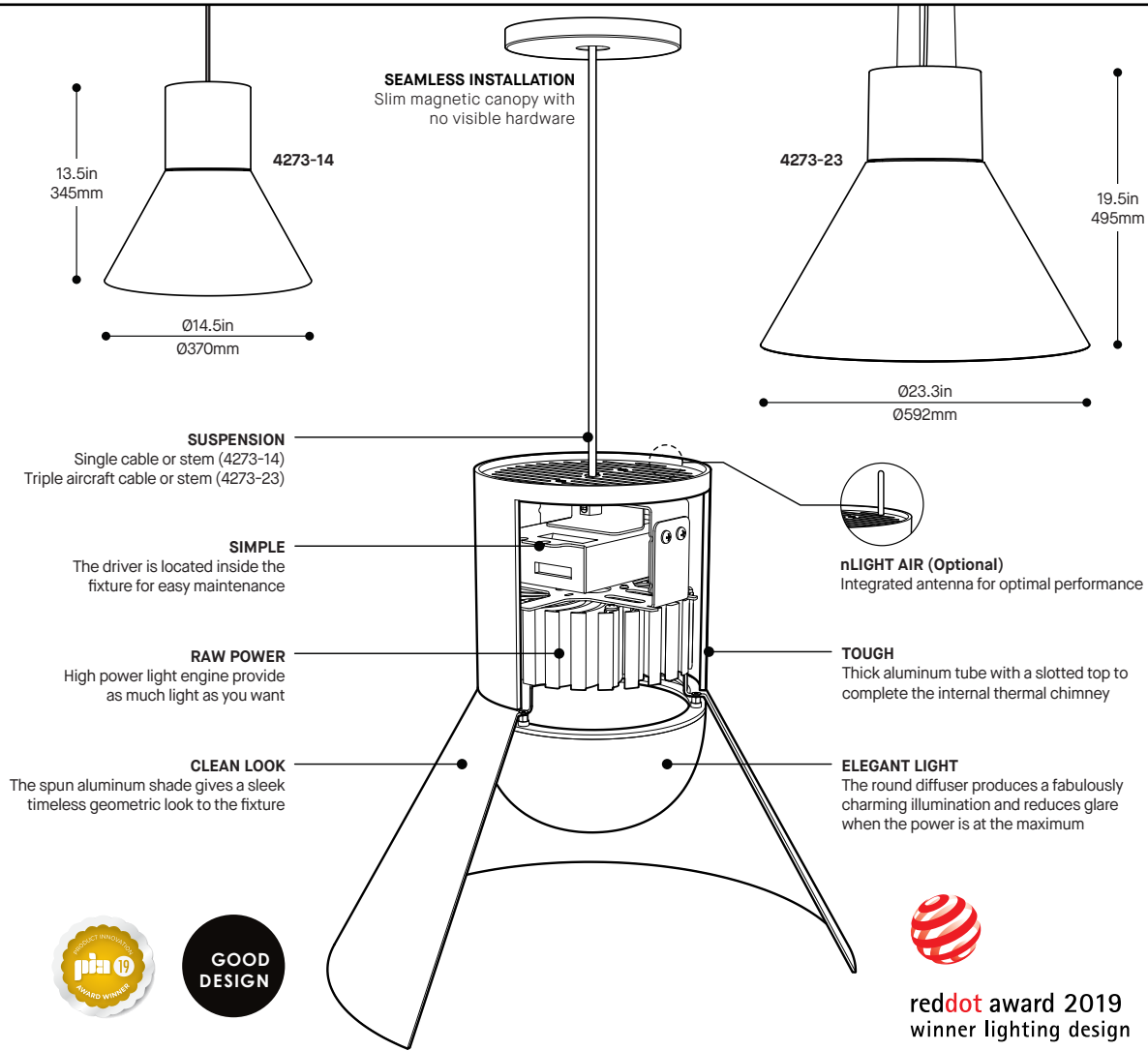

PRODUCT SPECIFICATION

	4273-14 REG — HO	4273-23 REG — HO
PERFORMANCE		
SYSTEM WATTAGE	28.7W — 51.3W	34.8W — 68.9W
DELIVERED DIRECT LUMENS (4000K)	2420LM — 4210LM	3200LM — 5560LM
EFFICACY	84.3LM/W	92.0LM/W
OTHER INFORMATIONS		
WEIGHT	7.7LBS / 3.5KG	8.2LBS / 3.7KG
L70 (LUMEN MAINTENANCE)	> 63 600 HRS	> 55 000 HRS
WELL & LEED STANDARD REQUIREMENTS		
MAX. LUMINANCE 45°-90° OF NADIR	5680(REG) CD/M ²	2944(HO) CD/M ²
LIGHT QUALITY	R9 > 50 (90 CRI OPTION)	
FLICKERING TOLERANCE	LOW FLICKER, COMPLIANT TO CALIFORNIA TITLE 24	

EFFICACY MULTIPLIERS

CRI	CCT	FACTOR
80+	4000K	1.00
80+	3500K	0.99
80+	3000K	0.97
80+	2700K	0.94
90+	4000K	0.89
90+	3500K	0.86
90+	3000K	0.84
90+	2700K	0.80

LIGHT DISTRIBUTION

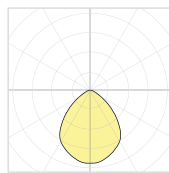

Visit our website for warranty terms and conditions.

VERNER 4273-XX

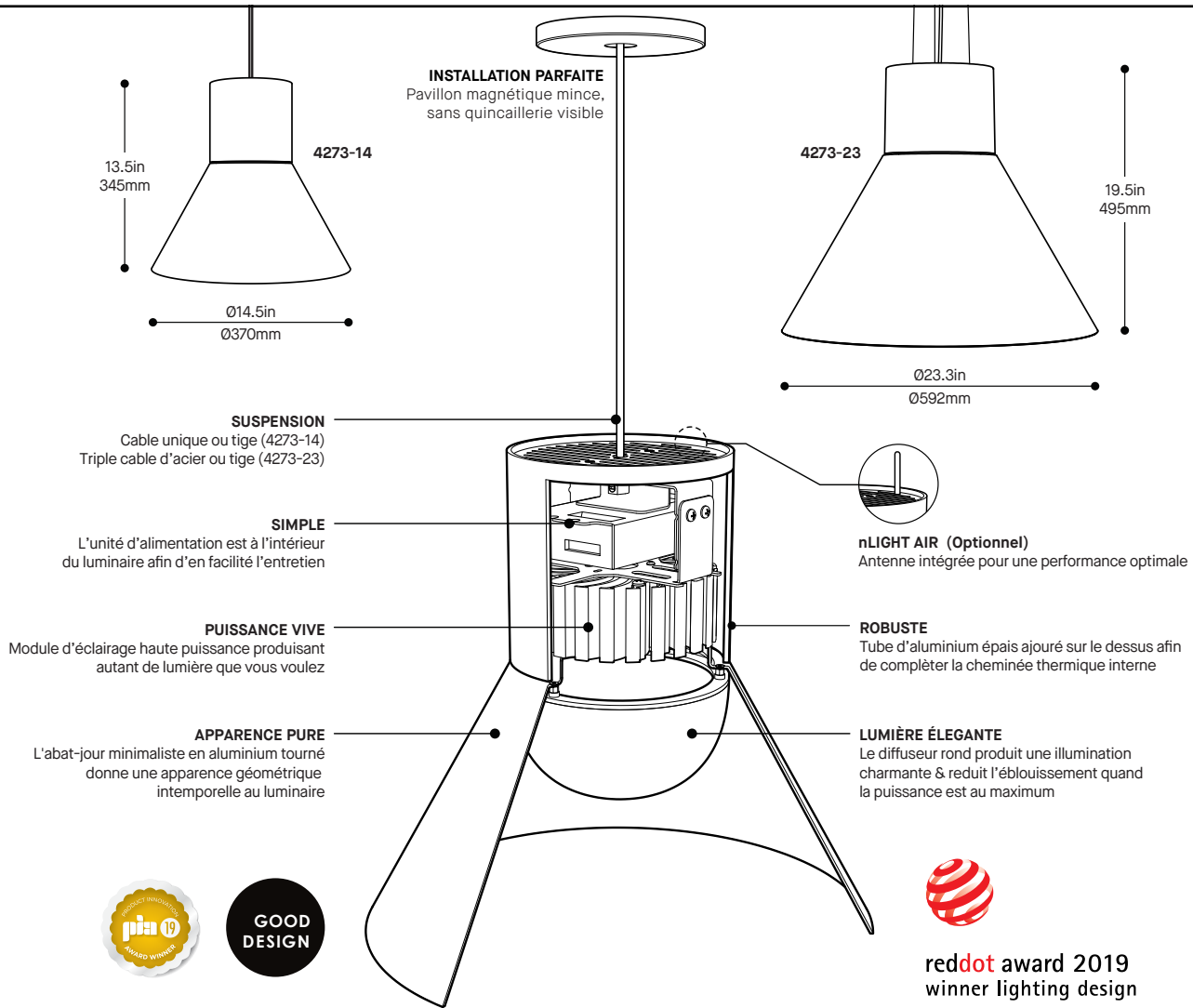

SPÉCIFICATION PRODUIT

	4273-14 REG – HO	4273-23 REG – HO
PERFORMANCE		
PUISSANCE TOTALE	28.7W – 51.3W	34.8W – 68.9W
LUMENS RÉELS DIRECT (4000K)	2420LM – 4210LM	3200LM – 5560LM
EFFICACITÉ	84.3LM/W	92.0LM/W
AUTRES INFORMATIONS		
POIDS	7.7LBS / 3.5KG	8.2LBS / 3.7KG
L70 (MAINTENANCE DE LA LUMIÈRE)	> 63 600 H	> 55 000 H
CRITÈRES DE CERTIFICATION WELL & LEED		
MAX. LUMINANCE 45°-90° NADIR	5680(REG) CD/M²	2944(HO) CD/M²
QUALITÉ DE LA LUMIÈRE	R9 > 50 (OPTION 90 IRC)	
TOLÉRANCE DE CLIGNOTEMENTS	PEU DE CLIGNOTEMENT (CONFORME À CALIFORNIA TITLE 24)	

FACTEUR D'EFFICACITÉ

IRC	CCT	FACTEUR
80+	4000K	1.00
80+	3500K	0.99
80+	3000K	0.97
80+	2700K	0.94
90+	4000K	0.89
90+	3500K	0.86
90+	3000K	0.84
90+	2700K	0.80

DISTRIBUTION LUMINEUSE

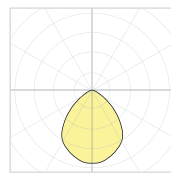

4273-XX



Visitez notre site Web pour les termes et conditions.