

# NANO 4033

PROJECT PROJET

SPEC TYPE

NOTES



## OVERALL HEIGHT HAUTEUR HORS TOUT

LIGHT SOURCE	LED TRACK 1 CIRCUIT	LED *	LED DIM * -8W 277V *
MOUNTING	2734E	2401C	2403G
STEM 4021	42.70"	40.20"	41.20"
STEM 4033	45.96"	43.46"	44.46"
FOR 2021/2033 ADD 1.60" FOR SWIVEL			
*FOR NO STEM / STEM ≤ 12IN - CANOPY 2401C + ACCESSORY 3983			

## MOUNTING OPTIONS OPTIONS DE MONTAGE

2734E	2401C	2403G
6.15" x 2.00" 156 x 51mm	Ø4.50" x 0.50" Ø114 x 13mm	Ø4.50" x 1.75" Ø114 x 44mm

\* OVERALL HEIGHT DOES NOT INCLUDE TRACK THICKNESS

## STEM OR CABLE OPTIONS OPTIONS DE TIGE OU CABLE

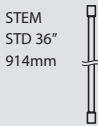

4033

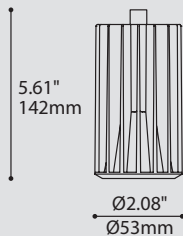

## ORDERING SPECIFICATION SPÉCIFICATION DE COMMANDE

CODE

### MODEL MODÈLE

4033 NANO (PENDANT)

4033

### LIGHT SOURCE SOURCE LUMINEUSE

(WATTAGE, LAMP TYPE, OTHER INFO)

LED.4 4W, LED

LED.8 8W, LED

### COLOR TEMPERATURE TEMPÉRATURE DE COULEUR

30 3000K

35 3500K

40 4000K

### ANGLE BEAM ANGLE DE FAISCEAU

17 17°

48 48°

### VOLTAGE VOLTAGE

120V 120 VOLT

277V\* 277 VOLT

\*NOT AVAILABLE WITH A TRACK ADAPTOR

### DIMMING OPTION OPTION DE GRADATION

DV\* 0-10V DIMMING (120-277V)

DP PHASE DIMMING (120V ONLY)

\*NOT AVAILABLE WITH A TRACK ADAPTOR

### STEM TIGE

S6 1/4" (6MM) STEM, FIELD ADJUSTABLE

### STEM LENGTH LONGUEUR DE TIGE

36 36" STEM (STD LENGTH)

\*\* CUSTOM STEM LENGTH (PLEASE SPECIFY)\*

FOR OVERALL LENGTH PLEASE CONTACT YOUR EUREKA REPRESENTATIVE.

\*3983 ACCESSORY PROVIDED FOR STEM ≤ 12", EXCEPT LED 8W 120V NON-DIMMING

### MOUNTING MONTAGE

RC\*



ROUND CANOPY / PAVILLON ROND

FOR LED NON-DIMMING & STEM ≤ 12": 0.50" CANOPY (2401C)

FOR DIMMING LED & 8W 277V: 1.75" CANOPY (2403G)

\*CANOPY FINISH ALWAYS CHROME

TA1



TRACK ADAPTOR / ADAPTATEUR DE RAIL\*

1 CIRCUIT

LED DIMMING & NON-DIMMING 120V ADAPTOR (2734E)

### MOUNTING OPTION OPTION DE MONTAGE

SCA\*

SLOPE CEILING ADAPTOR / ADAPTATEUR DE PLAFOND EN PENTE (ROTATION: 350°, PIVOT: 90°)

\*ONLY AVAILABLE WITH A STEM

### TRACK ADAPTOR FINISH FINI ADAPTATEUR DE RAIL<sup>(A)</sup>

WH

WHITE

BLK

BLACK

<sup>(A)</sup>FILL IN IF A TRACK ADAPTOR IS SELECTED, OTHERWISE LEAVE EMPTY

### STRUCTURE FINISH FINI STRUCTURE

CHR

CHROME

### HEATSINK FINISH FINI RADIATEUR

BLKA

BLACK ANODIZED

### ACCESSORY ACCESSOIRE

3983

DEEP JUNCTION BOX (PROVIDED FOR STEM ≤ 12" AS PER ABOVE)

## PRODUCT CHARACTERISTICS CARACTÉRISTIQUES DU PRODUIT



### DESIGN:

Nano and his little brother, Pico, pack a big punch in tiny formats. Their industrial look with visible heat sink allows for an impressive LED performance.

### LIGHT SOURCE:

4W and 8W LED with 0-10V (DV) or phase (DP) dimming versions available.

### STRUCTURE:

Die-cast aluminum heat sink with black satin anodized finish and inner die-formed steel parts with black polyester powder finish.

### CERTIFIED:

c-CSA-us, c-UL-us

# ANATOMY

BIM

DIM

IES

LED

2033  
2033B  
350°

2033  
2033B  
60°

NANO

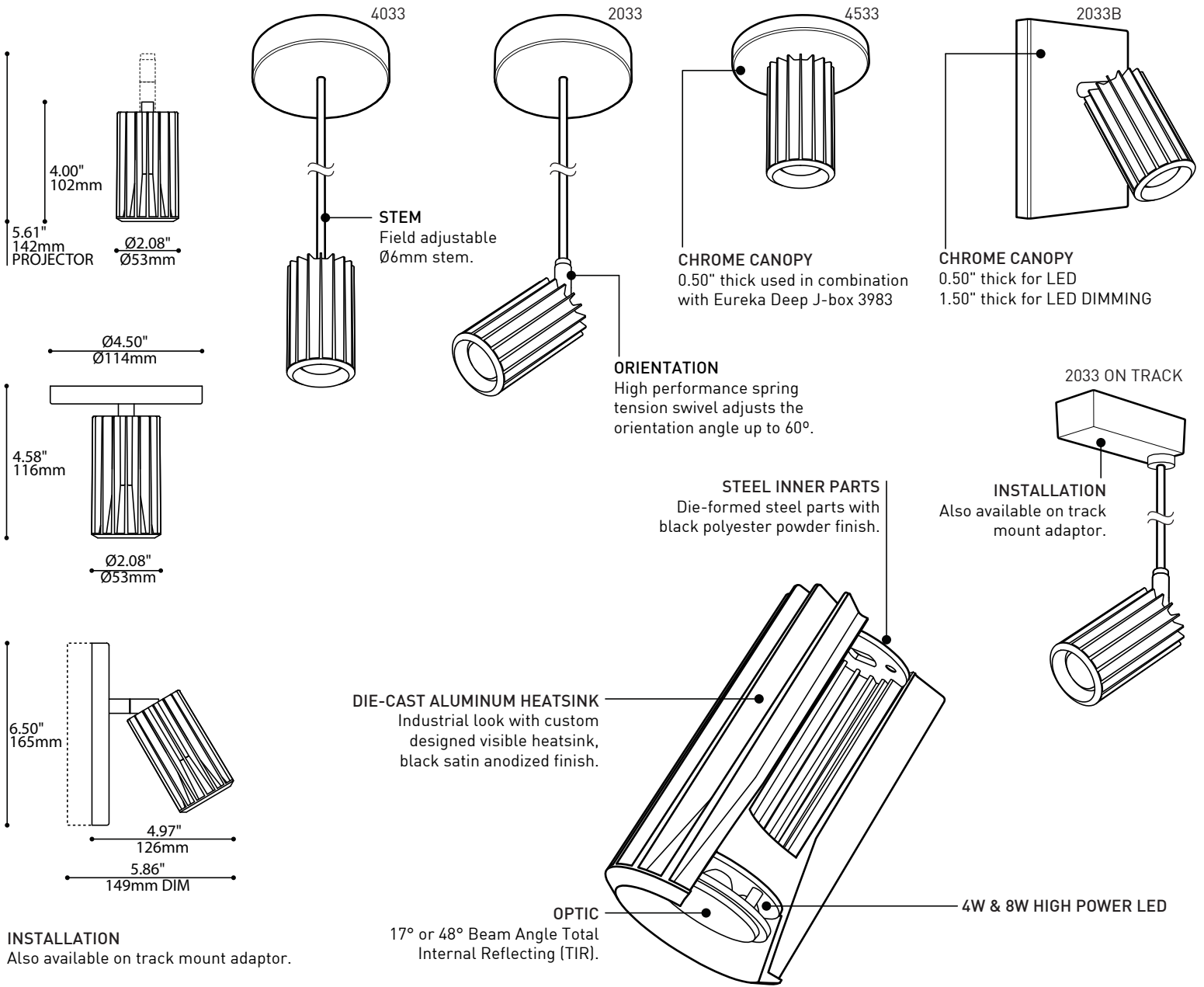

**INSTALLATION**  
Also available on track mount adaptor.

## SPECIFICATIONS

	4W LED	8W LED
LIGHT SOURCE	4x1W Nichia - System Wattage 4.8W Total	4x2W Nichia - System Wattage 9.9W Total
DELIVERED LUMENS	541 lm	1003lm
CRI	80 CRI (typical)	
CCT	3-step MacAdam Ellipse binning	
HEATSINK	Black anodized aluminum	
LIGHT DISTRIBUTION	Directional projector (2033/2033B) or Direct (4033/4533)	
OPTICS	Total Internal Reflection (TIR) of 17° & 48° beam angle	
VOLTAGE	120V (DP) and 120-277V (DV)	
DRIVER	Constant Current driver 350mA, UL Recognized	Constant Current driver 700mA, UL Recognized
DIMMING	Phase Dimming (DP) and 0-10V Dimming (DV)	
LM-79	On request	On request
WARRANTY	5 years	



225 de Liège Ouest, Suite #200  
Montréal (QC), Canada H2P 1H4  
Tel : 514.385.3515 Fax : 514.385.4169  
www.eurekalighting.com



2033 4033  
2033B 4533

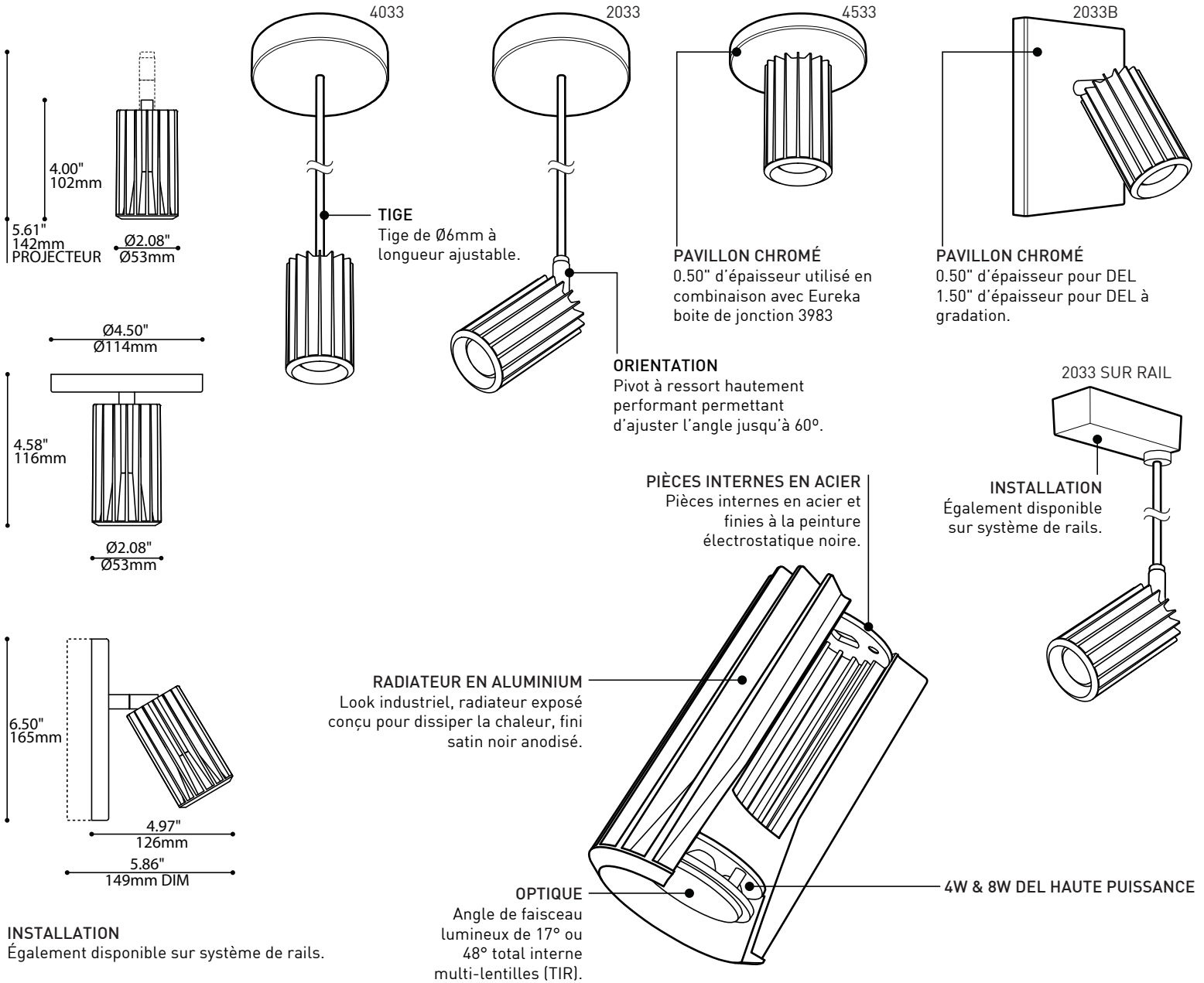

## SPECIFICATIONS

	4W DEL	8W DEL
SOURCE LUMINEUSE	4x Nichia - Puissance totale de 4.8 W	4x Nichia - Puissance totale de 9.9W
LUMENS RÉELS	541 lm	1003 lm
IRC	80 CRI (typical)	
CCT	3-step MacAdam Ellipse binning	
RADIATEUR	Aluminium anodisé noir	
DISTRIBUTION LUMINEUSE	Projecteur directionnel (2033/2033B) ou Direct (4033/4533)	
OPTICS	Angle de faisceau de 17° & 48° Réflexion totale interne (TIR)	
VOLTAGE	120V (DP) et 120-277V (DV)	
PILOTE	Courant Constant 350mA, Reconnu UL	Courant Constant 700mA, Reconnu UL
GRADATION	DP "phase dimming" et DV "0-10V dimming"	
LM-79	Sur demande	Sur demande
GARANTIE	5 ans	