

# DROP CELESTE 4427-CEL

PROJECT PROJÉT
SPEC TYPE
NOTES

ORDERING SPECIFICATION	SPÉCIFICATION DE COMMANDE	CODE
MODEL MODÈLE	4427-CEL DROP CELESTE	4427-CEL
CONFIGURATION CONFIGURATION		
303L	LEVELED CLUSTER 3 CABLES, 3 HEADS MIN. HEIGHT 17"	
303S	SPIRALED CLUSTER 3 CABLES, 3 HEADS MIN. HEIGHT 29"	
306S	SPIRALED CLUSTER 3 CABLES, 6 HEADS MIN. HEIGHT 47"	
309S	SPIRALED CLUSTER 3 CABLES, 9 HEADS MIN. HEIGHT 65"	
606S	SPIRALED CLUSTER 6 CABLES, 6 HEADS MIN. HEIGHT 47"	
612S	SPIRALED CLUSTER 6 CABLES, 12 HEADS MIN. HEIGHT 83"	
612M	MIXED CLUSTER 6 CABLES, 12 HEADS MIN. HEIGHT 83"	
618M	MIXED CLUSTER 6 CABLES, 18 HEADS MIN. HEIGHT 119"	
LIGHT SOURCE SOURCE LUMINEUSE	LED	
LED	REGULAR OUTPUT	
COLOR TEMPERATURE TEMPÉRATURE DE COULEUR		
27	2700K	
30	3000K	
35	3500K	
40	4000K	
COLOR RENDERING INDEX (CRI) INDICE DE RENDU DE COULEUR (IRC)	90	
90	90+ CRI	
VOLTAGE VOLTAGE		
120V	120 VOLT	
277V	277 VOLT	
CONTROL OPTION OPTION DE CONTRÔLE		
DV	0-10V DIMMING (120V-277V)	
NLTAIR2*	NLIGHT AIR CONTROL GEN 2	
NLIGHT*	NLIGHT WIRED CONTROL	
	*NLIGHT INTEGRATION REQUIRES A REMOTE POWER PACK (39NLAB FOR NLTAIR2 OR 39NLWB FOR NLIGHT) REFER TO NLIGHT GUIDE AND INSTALLATION SHEET FOR ALL REQUIREMENTS.	
CABLE CÂBLE	C	
C	BLACK CABLE, CONNECTOR MOUNTED, NOT FIELD ADJUSTABLE	
OVERALL HEIGHT HAUTEUR HORS TOUT		
**	CUSTOM OVERALL HEIGHT (PLEASE SPECIFY)	
	OVERALL HEIGHT MEASURED FROM CEILING TO BOTTOM OF FIXTURE CONFIGURATION PATTERN IS SET, ONLY UPPER CABLES ARE INFLUENCED BY OVERALL HEIGHT PLEASE REFER TO CONFIGURATION'S MINIMUM HEIGHT FOR SPECIFICATION	
CANOPY FINISH FINI PAVILLON		
BLKE	BLACK FINE TEXTURE	
WHE	WHITE FINE TEXTURE	
HEAD FINISH FINI TÊTE		
BLKE	BLACK FINE TEXTURE	
WHE	WHITE FINE TEXTURE	
GLASS FINISH FINI VERRE		
CLR	CLEAR GLASS	
FRO	FROSTED GLASS	
ACCESSORY ACCESSOIRE		
	ALL ACCESSORIES ARE AVAILABLE FOR ADVANCE SHIPPING	
39NLAB*	NLIGHT AIR GEN 2 REMOTE CONTROL BOX	
39NLWB*	NLIGHT WIRED REMOTE CONTROL BOX	
	*FOR CHICAGO PLENUM INSTALLATION, PLEASE CONTACT YOUR EUREKA REPRESENTATIVE.	

## CANOPY FINISH FINI PAVILLON



BLKE

WHE

## HEAD & GLASS FINISH FINI TÊTE & VERRE



BLKE CLR

BLKE FRO



WHE CLR

WHE FRO

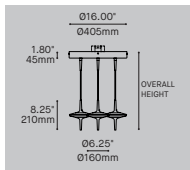

## CONFIGURATION CONFIGURATION

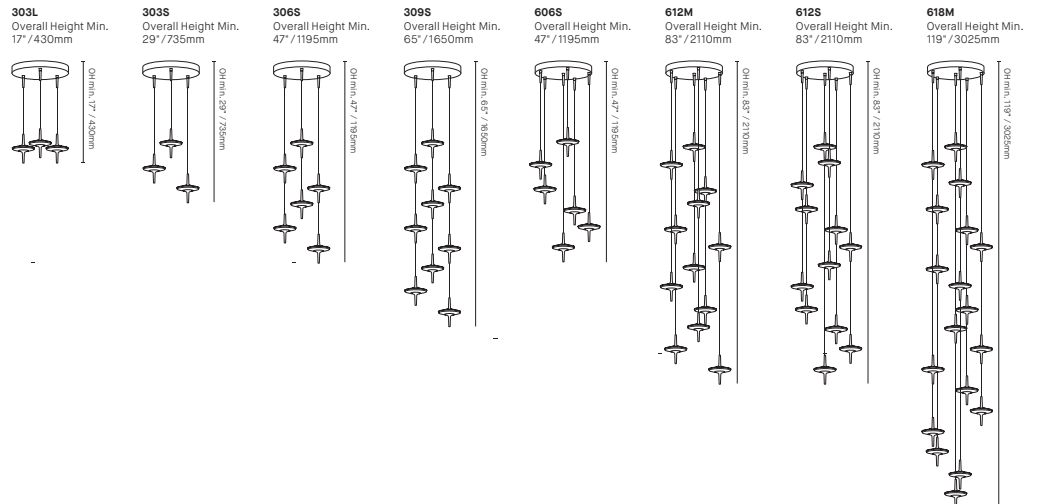

## CUSTOM CONFIGURATION

For custom or large-scale configurations, simply contact the factory and we will be pleased to discuss your design requirements.

## CONFIGURATION PERSONNALISÉE

Pour des configurations personnalisées ou à grande échelle, veuillez simplement contacter l'usine et nous serons heureux de discuter de vos exigences de conception.



## SPECIFICATION

# CELESTE

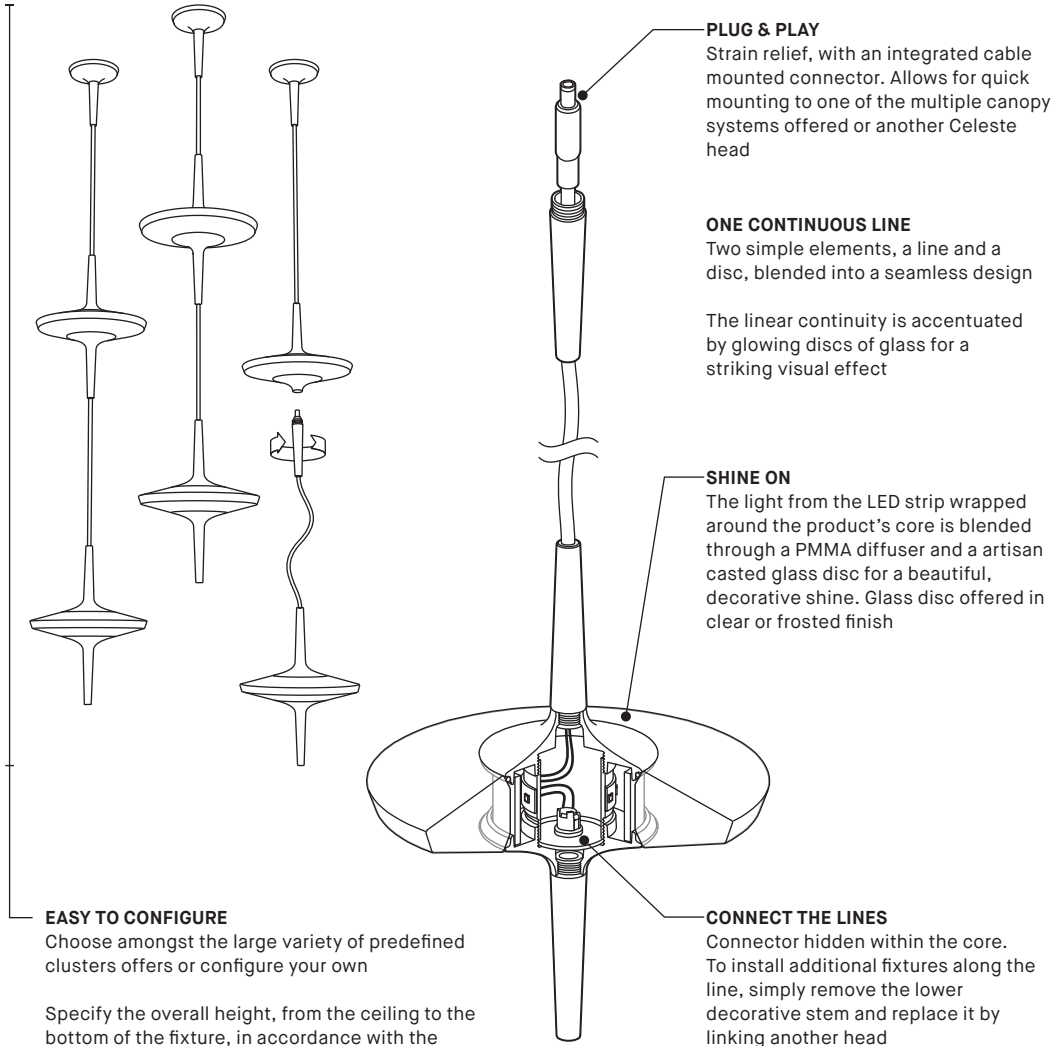

**EASY TO CONFIGURE**

Choose amongst the large variety of predefined clusters offers or configure your own

Specify the overall height, from the ceiling to the bottom of the fixture, in accordance with the configuration's minimum height and we'll take care of the rest

**PLUG & PLAY**

Strain relief, with an integrated cable mounted connector. Allows for quick mounting to one of the multiple canopy systems offered or another Celeste head

**ONE CONTINUOUS LINE**

Two simple elements, a line and a disc, blended into a seamless design

The linear continuity is accentuated by glowing discs of glass for a striking visual effect

**SHINE ON**

The light from the LED strip wrapped around the product's core is blended through a PMMA diffuser and a artisan casted glass disc for a beautiful, decorative shine. Glass disc offered in clear or frosted finish

**CONNECT THE LINES**

Connector hidden within the core. To install additional fixtures along the line, simply remove the lower decorative stem and replace it by linking another head

## CELESTE SYSTEMS



**DROPLET CELESTE 2447-CEL**

Remote junction box option  
Offered with 1, 3, 5, or 6 connector mounted mini canopies



**DROPLET CELESTE 2448-CEL**

Octagonal junction box mounting  
Offered with 1 connector mounted mini canopy and decorative plate covering the junction box

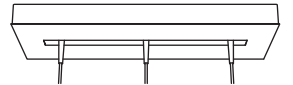

**ARRAY CELESTE 4425-CEL**

Offered with 3 or 5 connectors

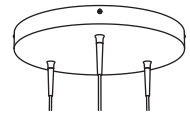

**DROP CELESTE 4427-CEL**

Offered with 3 or 6 connectors



**CELESTE 4010-CEL**

Extra head accessory light source  
Requires a Celeste system (sold separately)

**PRODUCT SPECIFICATION**      **XXX-CEL-CLR**      **XXX-CEL-FRO**

PERFORMANCE		
WATTAGE PER HEAD	3.8W	3.8W
DELIVERED LUMENS PER HEAD (4000K)	200 LM	235LM
OTHER INFORMATION		
LUMINAIRE'S WEIGHT	2.2LBS / 1KG	2.2LBS / 1KG
MAXIMUM HEADS PER CABLE	6 HEADS	6 HEADS
MAXIMUM HEADS ON SYSTEM	20 HEADS	20 HEADS

**EFFICACY MULTIPLIERS**

CRI	CCT	FACTOR
80	4000K	N/A
80	3500K	N/A
80	3000K	N/A
80	2700K	N/A
90	4000K	1.00
90	3500K	0.95
90	3000K	0.90
90	2700K	0.87

**LIGHT DISTRIBUTION**

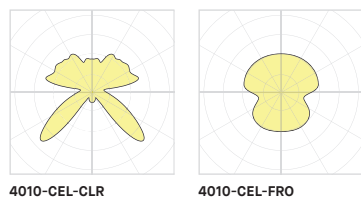

4010-CEL-CLR

4010-CEL-FRO



Visit our website for warranty terms and conditions.



## TECHNICAL DATA

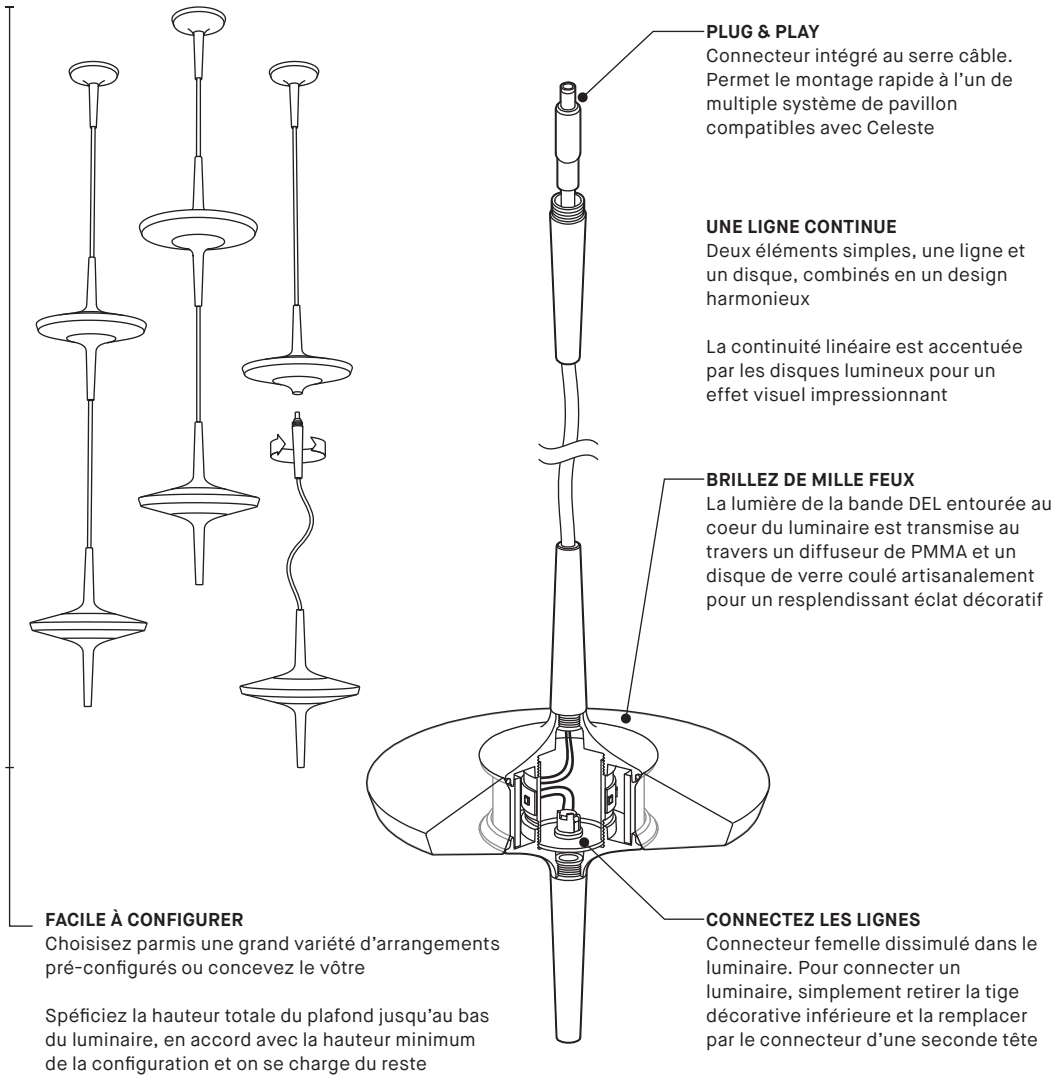

## SYSTÈMES CELESTE

**DROPLET CELESTE 2447-CEL**  
Option avec boîtes de jonction éloignée  
Offert avec 1, 3, 5, ou 6 mini pavillons munis de connecteurs

**DROPLET CELESTE 2448-CEL**  
Montage sur boîte de jonction octogonale  
Offert avec 1 mini pavillon muni d'un connecteur et une plaque décorative couvrant la boîte de jonction

**ARRAY CELESTE 4425-CEL**  
Offert avec 3 ou 5 connecteurs

**DROP CELESTE 4427-CEL**  
Offert avec 3 ou 6 connecteurs

**CELESTE 4010-CEL**  
Accessoire tête lumineuse supplémentaire  
Requiert un système Celeste (vendu séparément)

### SPÉCIFICATION PRODUIT

	XXX-CEL-CLR	XXX-CEL-FRO
<b>PERFORMANCE</b>		
<b>PUISSANCE PAR TÊTE</b>	3.8W	3.8W
<b>LUMENS RÉELS PAR TÊTE (4000K)</b>	200 LM	235LM
<b>AUTRES INFORMATION</b>		
<b>POIDS PAR TÊTE</b>	2.2LBS / 1KG	2.2LBS / 1KG
<b>MAXIMUM DE TÊTES PAR CABLE</b>	6 TÊTES	6 TÊTES
<b>MAXIMUM DE TÊTES SUR LE SYSTÈME</b>	20 TÊTES	20 TÊTES

### FACTEUR D'EFFICACITÉ

IRC	CCT	FACTEUR
80	4000K	N/A
80	3500K	N/A
80	3000K	N/A
80	2700K	N/A
90	4000K	1.00
90	3500K	0.95
90	3000K	0.90
90	2700K	0.87

### LIGHT DISTRIBUTION

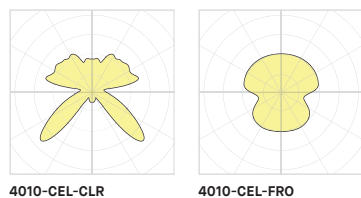

Visitez notre site Web pour les termes et conditions.